



ELECTRICAL HEATERS – USER GUIDE



**THIS USER MANUAL APPLIES TO THE FOLLOWING 3
ELECTRICAL HEATERS:**

MP752 – 2KW ELECTRIC HEATER

MP753 – 3KW ELECTRIC HEATER

MP755 - 5KW ELECTRIC HEATER

Please read and follow this operating manual and all safety instructions before using the heaters.

Keep these instructions for future reference. When passing the device on to others be sure to also include all documentation. The instruction leaflet is also available on our website

www.maypoleltd.com



ESSENTIAL SAFETY INFORMATION

- **IMPORTANT – TO AVOID A POTENTIAL FIRE & OVER HEATING NEVER COVER THE HEATER!**
- Do not use the heater near flammable or explosive objects.
- Make sure the heater is not used near objects that are easily deformed, discoloured or can deteriorate by heat.
- Ensure non-flammable objects are at least a distance of 1m away from the heater.
- **ALWAYS USE THE HEATER ON A SAFE AND STABLE SURFACE.**
- Do not insert any objects inside the heater.
- This appliance is not intended for unsupervised use by persons (including children) with reduced physical, sensory, or mental capabilities.
- Children must be supervised to ensure that they do not play with the appliance. Cleaning and user maintenance must not be undertaken by children.
- For indoor use only. Do not use in wet, damp, or dusty conditions.
- Never leave the heater un-attended.
- Never direct this heater directly towards infants, sleeping children or the elderly who may not be able to move away from the heat.
- Always ensure the power supply cable is located behind the heater not directly in front of the heater.
- Ensure the power supply is turned off when the heater is un-attended.
- Ensure that the supply cable is regularly inspected and kept in good condition.
- Never use the heater if it has been dropped or damaged in any way.
- There are no user-serviceable parts in this product. Opening the case is dangerous and electrical repairs or replacement of the cable should only be carried out by the manufacturer, its service agent or a suitably qualified electrician / electrical technician. Resultant damage to the product will result in the loss of your guarantee.

Only use this product for the purposes described in this instruction booklet. Failure to do so will result in the loss of your guarantee. The manufacturer will not accept liability for damage to the heater, persons or property resulting from incorrect usage or failing to follow the instructions in this booklet.

DISPOSAL

If this product must be disposed of, an authorised place for the recycling of electrical and electronic appliances must be sought. Contact your local authority for information concerning local Household Recycling Centres with applicable facilities.

This product must not be disposed of with general domestic waste.



COMPONENTS

- 1 x Electric heater
- 2 x thumb wheels
- 2 x M8 flat washers
- 2 x M8 spring washers
- 1 x stand bracket

INSTALLATION

Secure the stand to the heater but inserting the thumb wheel through the stand bracket hole and into the corresponding hole on the side of the heater. Ensure a flat and spring washer is in place. Tighten the thumb wheel to secure. Repeat on the opposite side of the heater.

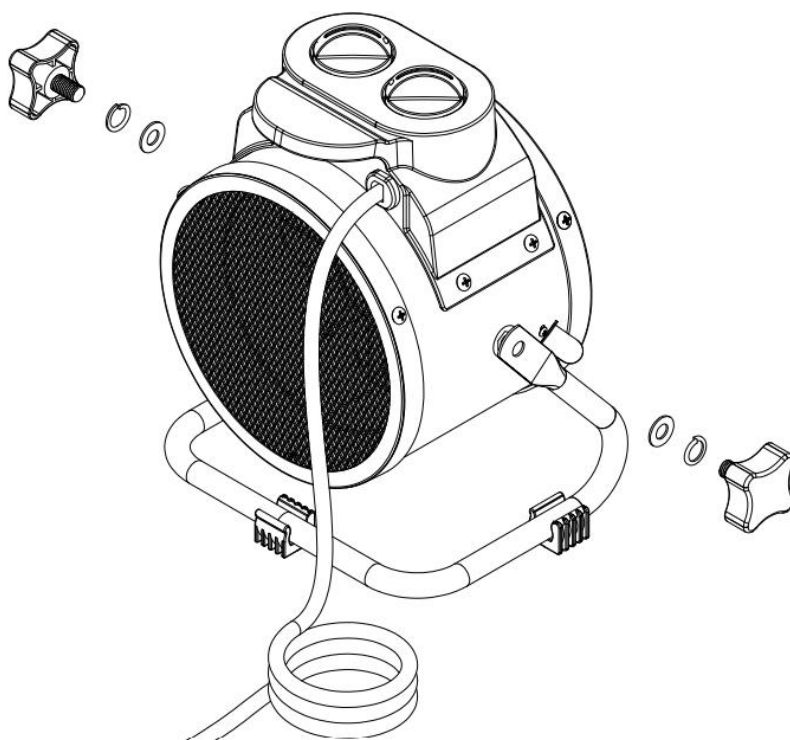

NOTE – MP753 (3KW heater) & MP755 (5KW heater) are both supplied without a plug. You must therefore contact a qualified electrician to ensure that a suitable power supply is available. We recommend the use of an industrial round pin plug and socket (IEC60309) this should be discussed with your electrician. Use of an RCD to protect this circuit is also recommended.



PRODUCT LAYOUT



OPERATIONAL PANEL

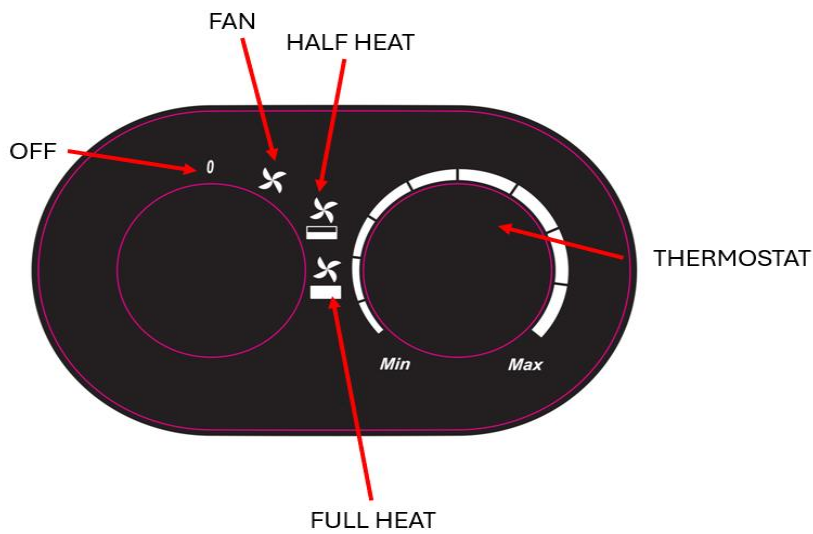

PRODUCT FEATURES

The Maypole electrical heaters have 3 settings (fan/ half heat/ full heat) which can be selected using the rotary switch. The thermostat can be adjusted to control and maintain a constant room temperature.

The heaters use the latest PTC technology to provide energy efficient heat which is quiet



and fume free.

The heaters contain built in over heating protection.

The heaters are portable & lightweight and include an adjustable frame.

Model	Rated input voltage	Phase number & frequency	Supply Current	Full power	Half power	Approx sqm coverage
MP752	230V	Single phase, 50Hz	11Amp	2KW	1KW	60sqm
MP753	230V	Single phase, 50Hz	16Amp	3KW	1.5KW	90sqm
MP755	230V	Single phase, 50Hz	27Amp	5KW	2.5KW	144sqm

OPERATION

Before using the heater, ensure the power supply voltage matches the power supply of the heater.

Do not use a power socket or extension lead with a supply capacity less than the ratings shown above.

The following options can be selected on the control panel:

‘O’ turns the heater off. The fan or heater will not work.



activates the fan. This is recommended for indoor cooling.



activates half heat output.



activates full heat output.

Use the thermostat control to adjust room temperature. Rotate the dial clockwise for a higher room temperature and anti-clockwise for a lower room temperature.

If the air outlet is obstructed or covered, the heater temperature will become too high and the internal automatic thermal protection device will operate, stopping further heat output. Once the heater has cooled down (approx. 30 mins) the protection device will automatically reset and heat output will continue.



TROUBLE SHOOTING

Fault	Reason	Solution
No heat output	Connection problem of the power supply	Ensure to correct power supply is used
	The heating option is not selected	Ensure either half heat or full heat is selected on the control panel
	Overheated	Wait approx. 30 mins for the heater to cool down

MAINTENANCE INSTRUCTIONS

This heater requires minimal maintenance. As with any appliance, a few common sense rules will prolong the life of the heater.

ALWAYS MAKE SURE THE HEATER IS DISCONNECTED FROM A MAINS SUPPLY PERFORMING ANY MAINTENANCE OR CLEANING.

1. Store in a clean, dry place to avoid moisture damage.
2. Loosely coil up the supply cable when not in use.
3. Clean the case and supply cable with a slightly damp cloth. Never use petrol or other flammable liquids to clean the heater. Ensure the heater is fully dry before operation.
4. Examine the supply cable periodically for cracking or other damage and have it replaced if necessary.
5. WARNING: All other servicing should be done by qualified personnel only.

DECLARATION OF CONFORMITY

We declare that this product conforms to the following standards:



EMC Standard EN IEC 55014-1:2001; EN 61000-3-12:2011; EN IEC 61000-3-11:2019; EN IEC 55014-2:2021

ROHS 2011/65/EU Annex II and its subsequent amendments Directive (EU) 2015/863

Technical Manager Maypole Ltd June 2024

Email: sales@maypoleltd.co.uk

Web: www.maypoleltd.com